

**RAILING FOR HEADWALL/WINGWALL INSTALLATIONS
(NTS)**

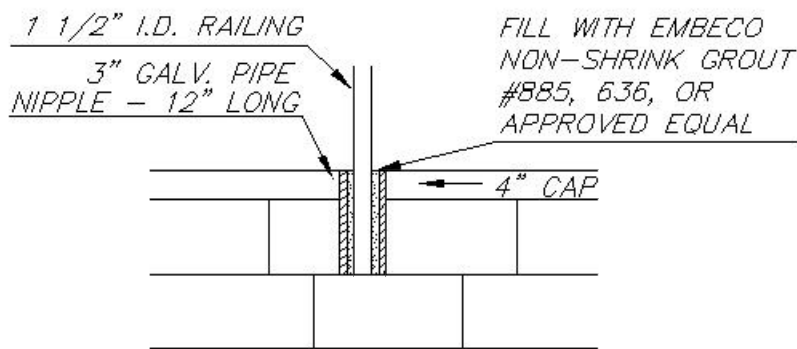

WALL TYPE VARIES

INSTALLATION FOR WALL 12" AND LARGER IN THICKNESS

NOTE: WALL MAY BE DRILLED IN LIEU OF SETTING SLEEVE—SAME CAULKING REQUIRED.

SLEEVE DETAIL FOR HANDRAIL (NTS)

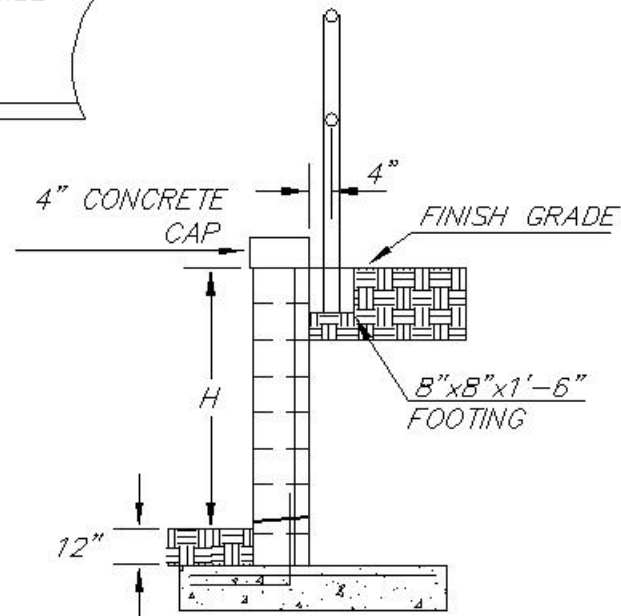

**INSTALLATION FOR WALLS LESS THAN 12" THICKNESS
(NTS)**

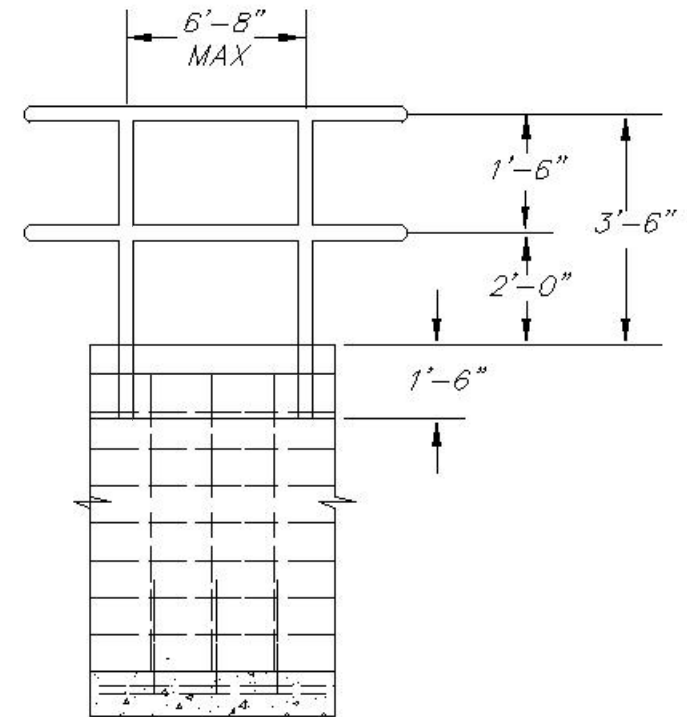

RAILING IS REQUIRED WHEN H=2.5' OR MORE FOR RETAINING WALLS. ALL RAILING IS TO BE OF 1.5" I.D. SCHEDULE 40 BLACK OXIDE STEEL PIPE. IT SHALL BE PRIMED ACCORDING TO MFG. RECOMMENDATIONS AND ALUMINUM PAINTED.

**TYPICAL HANDRAIL DETAIL
(NTS)**

REVISED	F.B.	PG.	DATE: 2-16-94
03/27/95			SCALE: NONE
			DRAWN BY: DYS, DBD
			CHECKED BY: FAP
			CITY ENGINEER: JPB

STANDARD DETAIL

HANDRAIL DETAIL

OFFICE OF THE
CITY ENGINEER
GASTONIA, N.C.

FILE NO. **71C-35**