

THIS AREA PAINTED WITH REFLECTORIZED PAINT (YELLOW). SLOPE 1/4" PER FOOT EITHER WAY AS REQUIRED BY STREET CROWN.

SEE STD. DETAIL 71D-1 FOR ABC STONE BASE REQUIREMENT

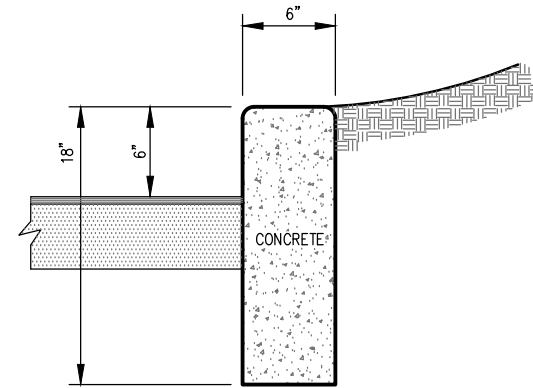

TYPE "A"

RECESSED MOUNTABLE ISLAND

STANDARD VERTICAL CURB

NOTE:

WHEN "A" IS 3' OR LESS "B" MUST BE 12" AND THE JOINTS MAY BE OMITTED. WHEN "A" IS GREATER THAN 3', "B" MUST BE 3" MIN. AND THE JOINTS MUST BE USED. C.A.B.C. OR COMPACTED EARTH MAY BE USED UNDER THE 3" CONCRETE COVERING.

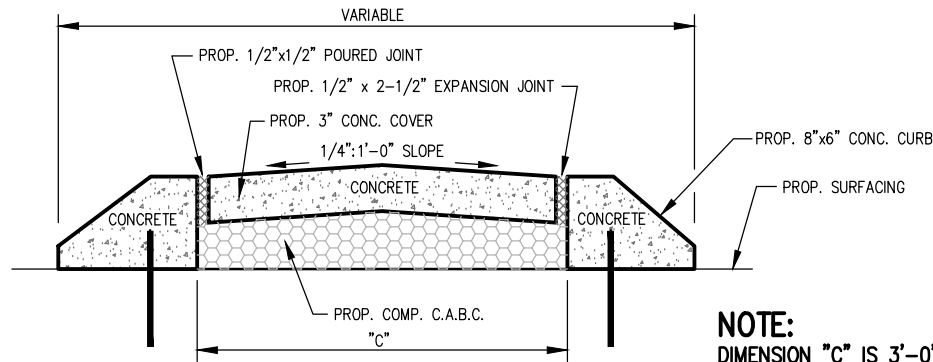

TYPE "B"

DOWELED TYPE MOUNTABLE ISLAND

NOTE:

DIMENSION "C" IS 3'-0" MIN. WHEN "C" IS 4'-0" OR LESS OMIT THE LONGITUDINAL JOINTS AND C.A.B.C. AND USE SOLID CONCRETE.

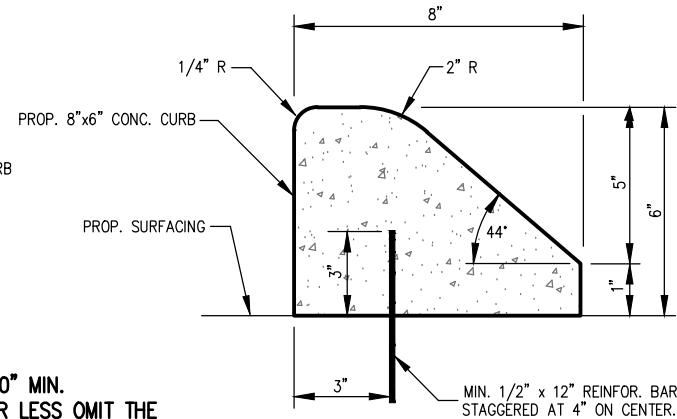

REVISED	DATE: 01-28-74	Standard Detail Concrete Island and Vertical Curb Detail	OFFICE OF THE CITY ENGINEER GASTONIA, N.C.
03/02/00	SCALE: NONE		FILE NO. 71D-13
04/18/17	DRAWN BY: DNC, MGB		
	CHECKED BY: NEM, FAP,TAJ		
	CITY ENGINEER: JPB, CCB		