

NOTES: ALL WARNING SIGNS TO BE A MIN. OF 36" X 36"
 & TO BE REFLECTORIZED WHEN USED AT NIGHT.
 — ALL TRAFFIC CONTROL SIGNS, FLASHING BARRICADES,
 ETC. WILL BE FURNISHED & MAINTAINED BY THE
 CONTRACTOR UNTIL OBSTRUCTION IS REPAIRED
 *PAVEMENT OBSTRUCTION=BROKEN PAVEMENT,
 LOOSE GRAVEL, ETC.

THIS METHOD TO BE USED WHEN SPACE DOES NOT
 PERMIT USE OF METHOD OUTLINED IN M.U.T.C.D.

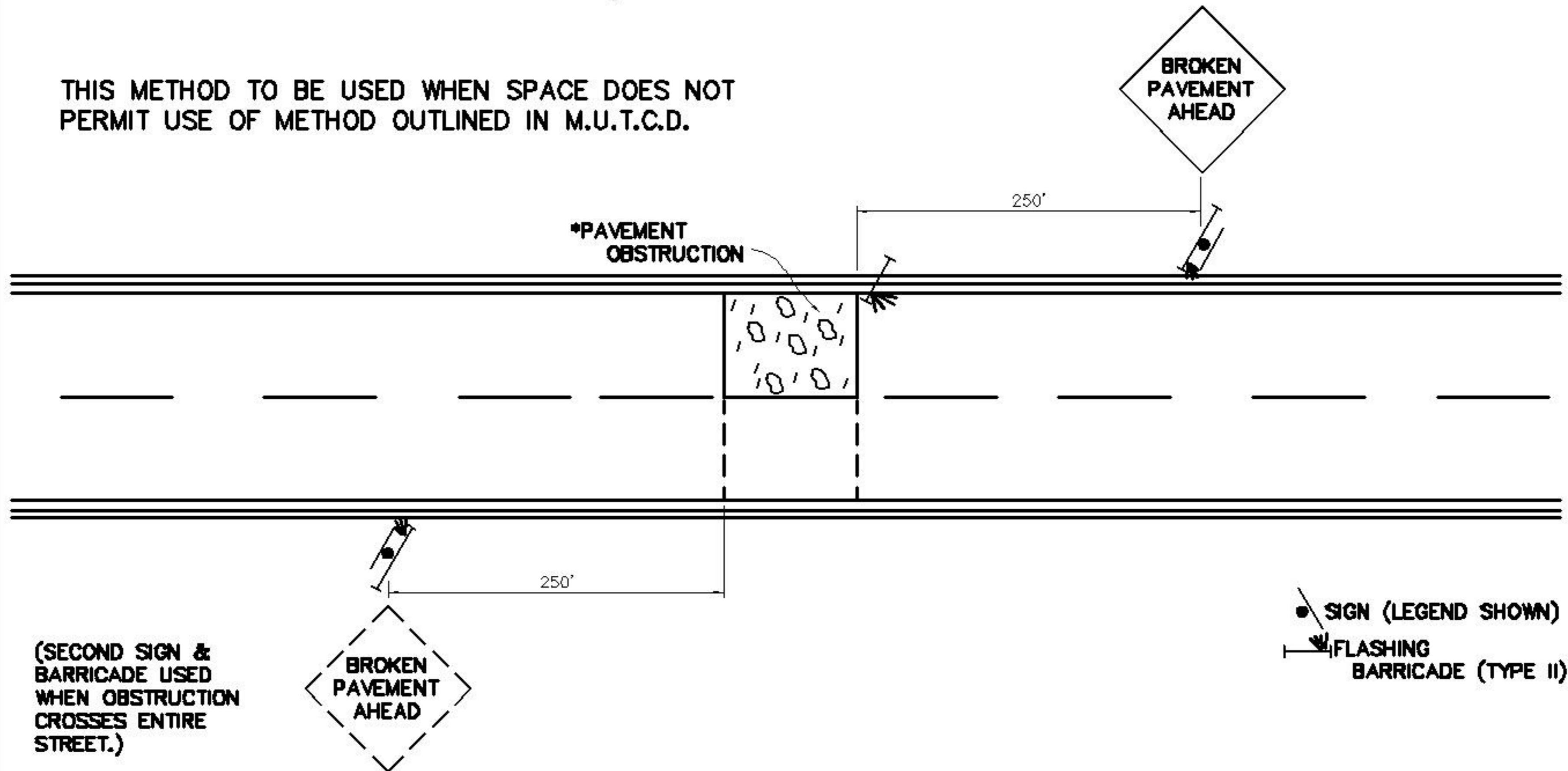

REVISED	F.B.	PG.	DATE: 7-30-85
			SCALE: NONE
			DRAWN BY: P.N.R.
			CHECKED BY: DKL
			CITY ENGINEER: DEC

STANDARD DETAIL
SIGN CONSTRUCTION & MAINTENANCE
OPERATION ON TWO LANE STREETS
WHERE ONE LANE IS CLOSED

OFFICE OF THE
 CITY ENGINEER
 GASTONIA, N.C.

FILE NO. **71E-12**